



Depicted chain container optionally available.

Option

- Stainless steel load chain (no reduction of working load limit).
- Robust chain container.
- Festooned cable systems.
- Low voltage control 48V.
- Manual and powered trolleys with clevis or shackle to fit top hook suspended chain hoists.

Electric chain hoist model CPS with suspension hook

Capacity 125 - 500 kg

The model CPS is the smallest and lightest within the family of Yale electric chain hoists. Reliability and compact design make it ideal for numerous applications in the construction industry, service companies and many industrial areas for moving small and medium loads.

Features

- Classification 1 Am. As required the model CPS (with appropriate changes to lifting capacity resp. duty cycle) can also be rated up to higher classifications.
- The standard version comes with direct control.
- Two year warranty (excluding wear parts).
- Thermal overload protection as standard.
- Duty cycle 30% ED, resp. 25% ED.
- Safe hold of the load even in case of electric failure due to electromagnetic, spring pressure brake.
- Standard operating current:
Euro-voltage 400V, 3-phase, 50 Hz.
125 kg capacity also available for
230V, single phase, 50 Hz.
- Motor protected to IP 54, against ingress of dust and water.
- Pendant control protected to IP 65, against ingress of dust and spray water.
- The overload protection (slip clutch) avoids overloading and extends the lifetime of the hoist.
- Robust aluminium housing, powder coated.
- Extremely low headroom.
- The standard case hardened and zinc-plated link chain is matched perfectly to the hoist and guarantees smooth and precise chain motion. All requirements of national and international standards and regulations are fulfilled.
- The 10-pocket load sheave ensures smooth running of the chain and minimizes chain wear.
- Forged suspension and load hooks, manufactured from non-aging, high alloy tempering steel, yield under overload instead of breaking.

Hoisting Equipment Electric chain hoists

Technical data model CPS

Model	EAN-No. 4025092*	Capacity kg	Number of chain falls	Standard lifting height m	Chain dimension d x p mm	Lifting speed m/min	Hoist motor kW	Weight kg	Operating current	FEM classifica- tion
CPS 1-4	*076654	125	1	3	4 x 12.2	4	0.10	11.5	230V/1 Ph/50 Hz	1 Am
CPS 1-10	*076661	125	1	3	4 x 12.2	10	0.25	11.5	400 V/3 Ph/50 Hz	1 Am
CPS 2-6	*076678	250	1	3	4 x 12.2	6	0.28	11.5	400V/3 Ph/50 Hz	1 Am
CPS 5-3	*076685	500	2	3	4 x 12.2	3	0.28	12.5	400V/3 Ph/50 Hz	1 Am

Dimensions model CPS

Model	CPS 1-4	CPS 1-10	CPS 2-6	CPS 5-3
A, mm	276	276	276	303
B, mm	98	98	98	146
C, mm	159	159	159	159
D, mm	75	75	75	60
E, mm	76	76	76	91
F, mm	160	160	160	160
G, mm	227	227	227	227
H, mm	103	103	103	103
I, mm	52	52	52	52
J*, mm	1905	1905	1905	1905
X, mm	25	25	25	25
Y, mm	14	14	14	14
Z, mm	21	21	21	21

*Dimensions for standard 3 m lift.

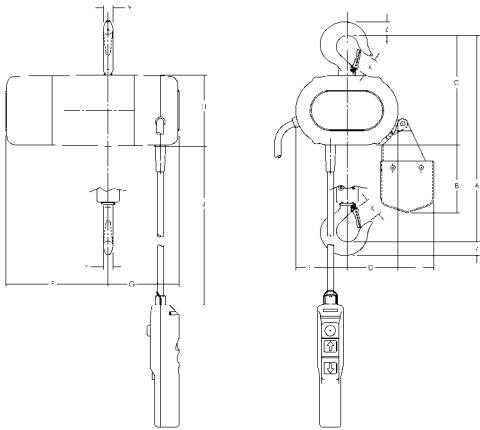

Smallest and lightest electric chain hoist for a great number of applications.

Model CPS

Yale hoists and trolleys are not designed for passenger elevation applications and must not be used for this purpose.



Festooned cable systems
see page 104-105

Option

- Suspension hook
- Flexible chain container.
- Manual and electric trolleys.
- Festooned cable system.
- Stainless steel load chain.
- Remote control
(in combination with integrated trolley).
- Other operating voltages

Electric chain hoist model YaleVeGo with suspension lug or with integrated trolley

new!

Capacities 125 - 2.000 kg

The new electric chain hoist model YaleVeGo combines modern design and technical innovation. A robust construction makes the series a versatile tool for professional applications. The **integrated limit switch** for the highest and lowest hook position considerably extends the working life span of the slip clutch, motor and gearbox.

Features

- Classification 1 Am. As required (with appropriate changes to lifting capacity resp. duty cycle) the model YaleVeGo can also be re-classified up to 3 m.
- Main contactor as standard, for increased safety.
- 2 year warranty (excluding wear parts) and a lifetime lubricated gearbox.
- Thermal overload protection as standard for the whole range. Optimised housing for improved cooling.
- Duty cycle **50 % ED** for single speed.
- Electromagnetic spring pressure brake holds the load safely even in the event of power failure.
- The externally adjustable **slip clutch** is designed to guarantee a **permanent connection between the load and the brake**.
- Motor protected to **IP 55** (acc. to VDE 0530), against ingress of dust or water.
- Standard operating voltage: 400 V, 3-phase, 50 Hz, alternatively 460 V, 3-phase, 60 Hz. Single speed motors reconnectable to 230 V, 3-phase, 50 Hz.
- Increased operating safety through **42 V control voltage (low voltage control)** and an encapsulated pendant control to IP 65.
- Suspension lug for compact dimensions and easy integration in closed-eye constructions.
- Chain guide made of fibre coated polyamide for increased wear resistance.
- The standard, oil bath lubricated and case hardened gearbox has a helical gearing for **particularly smooth running** and enhanced lifetime.

Technical data model YaleVego CPV/CPVF

Model	Capacity in kg/ number of chain falls	Chain dimension d x p mm	FEM classification	Lifting speed main lift m/min	Lifting speed fine lift m/min	Hoist motor kW	Motor rating ED %	Net weight* suspension lug kg	Net weight* push trolley** kg	Net weight* electric trolley*** kg
CPV 1-8	125/1	4 x 12.2	3 m	8	-	0.19	60	24	39	47
CPVF 1-8	125/1	4 x 12.2	3 m	8	2	0.19/0.05	40/20	25	40	48
CPV 2-8	250/1	4 x 12.2	1 Am	8	-	0.37	50	24	39	47
CPVF 2-8	250/1	4 x 12.2	1 Am	8	2	0.37/0.09	33/17	25	40	48
CPV 5-4	500/2	4 x 12.2	1 Am	4	-	0.37	50	25	40	48
CPVF 5-4	500/2	4 x 12.2	1 Am	4	1	0.37/0.09	33/17	26	41	49
CPV 5-8	500/1	5 x 15.1	1 Am	8	-	0.75	50	26	41	49
CPVF 5-8	500/1	5 x 15.1	1 Am	8	2	0.75/0.18	33/17	27	42	50
CPV 10-4	1000/2	5 x 15.1	1 Am	4	-	0.75	50	28	43	51
CPVF10-4	1000/2	5 x 15.1	1 Am	4	1	0.75/0.18	33/17	29	44	52
CPV 10-8	1000/1	7.1 x 20.5	1 Am	8	-	1.5	50	58	77	84
CPVF10-8	1000/1	7.1 x 20.5	1 Am	8	2	1.5/0.37	33/17	59	78	85
CPV 20-4	2000/2	7.1 x 20.5	1 Am	4	-	1.5	50	63	82	89
CPVF 20-4	2000/2	7.1 x 20.5	1 Am	4	1	1.5/0.37	33/17	64	83	90

*Weight for standard 3 m lift. Other lifting heights on request.

**For trolleys type A and B: Additional weight for geared trolley (VTG): 2.5 kg.

***For electric trolley (VTE) with 2 speeds +2.0 kg.

Yale hoists and trolleys are not designed for passenger elevation applications and must not be used for this purpose.



Increased operating safety through 42V control voltage



Externally adjustable slip clutch.



Integrated limit switch



Depicted suspension hook and chain container optionally available.

Encapsulated pendant control.

Option: remote control (in combination with integrated trolley).

Technical data trolleys

Suitable for model	Capacity kg	Size	Beam flange width b mm	Beam flange thickness t max. mm	Curve radius min. m	Electric trolley travel speed m/min at 50 Hz	Electric trolley motor kW at 50 Hz
from CPV 1-8 up to CPVF 10-4	1000	A	58 - 180	19	0.9	18 or 18/4.5	0.18 or 0.18/0.06
from CPV 1-8 up to CPVF 10-4	1000	B	180 - 300	19	0.9	18 or 18/4.5	0.18 or 0.18/0.06
from CPV 10-8 up to CPVF 20-4	2000	A	58 - 180	19	1.15	18 or 18/4.5	0.18 or 0.18/0.06
from CPV 10-8 up to CPVF 20-4	2000	B	180 - 300	19	1.15	18 or 18/4.5	0.18 or 0.18/0.06

Dimensions model YaleVego CPV/CPVF

Model	CPV/CPVF 1-8	CPV/CPVF 2-8	CPV/CPVF 5-4	CPV/CPVF 5-8	CPV/CPVF 10-4	CPV/CPVF 10-8	CPV/CPVF 20-4
A, mm	353	353	393	353	430	428	524
A1, mm	196	196	196	196	196	234	234
A2 (Size I), mm	376	376	376	376	376	464	464
A2 (Size II), mm	426	426	426	426	426	544	544
A2 (Size III), mm	506	506	506	506	506	-	-
B, mm	22	22	22	22	29	29	37
B1, mm	15	15	15	15	15	20	20
C, mm	29	29	29	29	35	35	40
C1, mm	38	38	38	38	38	45	45
D, mm	15	15	15	15	21	21	26
D1, mm	15	15	15	15	15	15	15
E, mm	277	277	277	277	277	326	326
G, mm	120	120	144	120	144	140	173
G1 (Size I), mm	142	142	142	142	142	208	208
G1 (Size II), mm	162	162	162	162	162	208	208
G1 (Size III), mm	162	162	162	162	162	-	-
H, mm	157	157	133	157	133	186	154
K (CPV), mm	207	207	207	207	207	285	285
K (CPVF), mm	207	207	207	207	207	285	285
M (Size I), mm	162	162	162	162	162	208	208
M (Size II), mm	197	197	197	197	197	208	208
M (Size III), mm	197	197	197	197	197	-	-
N, mm	219	219	219	219	219	274	274

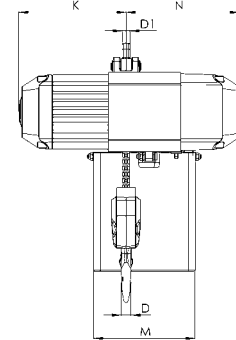
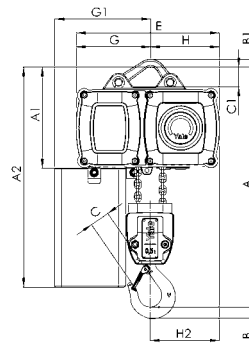
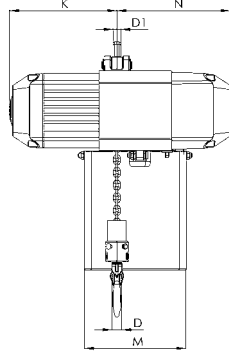
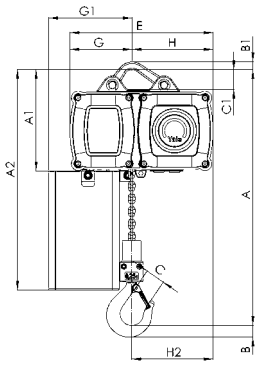

Model YaleVego CPV/CPVF with suspension lug, 125 - 1000 kg, single fall

Model YaleVego CPV/CPVF with suspension lug, 500 - 2000 kg, double fall

Dimensions model YaleVego CPV/CPVF

Model	CPV/CPVF 1-8	CPV/CPVF 2-8	CPV/CPVF 5-4	CPV/CPVF 5-8	CPV/CPVF 10-4	CPV/CPVF 10-8	CPV/CPVF 20-4
A3, mm	228	228	228	228	228	263	263
A4 (Size I), mm	408	408	408	408	408	493	493
A4 (Size II), mm	458	458	458	458	458	573	573
A4 (Size III), mm	538	538	538	538	538	-	-
A5, mm	385	385	425	385	462	456	553
b, mm	A = 50 - 180/ B = 180 - 300	A = 50 - 180/ B = 180 - 300	A = 50 - 180/ B = 180 - 300	A = 50 - 180/ B = 180 - 300	A = 50 - 180/ B = 180 - 300	A = 50 - 180/ B = 180 - 300	A = 50 - 180/ B = 180 - 300
H1, mm	24	24	24	24	24	23	23
H2, mm	158	158	158	158	158	186	186
H3, mm	129	129	129	129	129	129	129
H4 (VTG), mm	95	95	95	95	95	95	95
H4 (VTE), mm	120	120	120	120	120	120	120
I (VTP), mm	72	72	72	72	72	96	96
I (VTG), mm	77	77	77	77	77	98	98
L (VTP/VTG), mm	310	310	310	310	310	360	360
L1, mm	130	130	130	130	130	150	150
L2 (CPV), mm	265	265	265	265	265	265	265
L2 (CPVF), mm	265	265	265	265	265	265	265
L3, mm	155	155	155	155	155	180	180
L4, mm	161	161	161	161	161	203	203
O, mm	60	60	60	60	60	80	80
P, mm	200	200	200	200	200	200	200
P1, mm	246	246	246	246	246	246	246
S, mm	b + 50	b + 50	b + 50	b + 50	b + 50	b + 54	b + 54
T, mm	95	95	95	95	95	95	95
tmax., mm	19	19	19	19	19	19	19

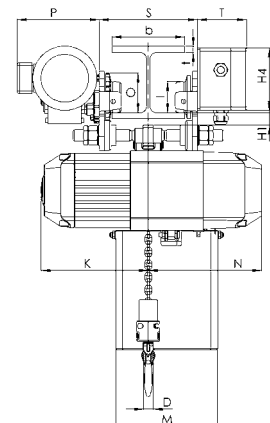
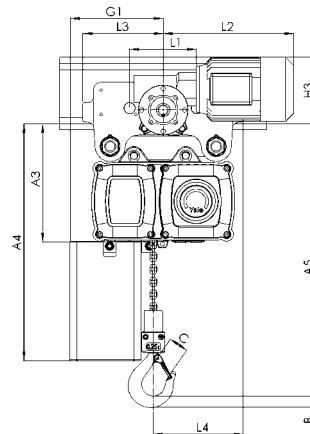
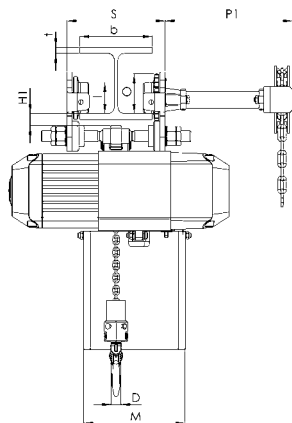
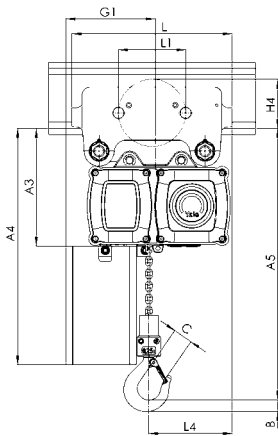

Model YaleVego CPV/CPVF with integrated manual push or geared trolley

Model YaleVego CPV/CPVF with integrated electric trolley



Electric chain hoist model CPE with suspension hook or with integrated trolley

Capacity 1600 - 10000 kg

The CPE series is a range of high quality products for professional applications. They are highly efficient and engineered for a long working life. The hoists are composed of three main component parts which makes service easy and inexpensive.

Features

- Classification 1 Am, except models CPE(F) 20-8, CPE(F) 30-5 and CPE(F) 40-4 classification 1 Bm.
- The standard version comes with direct control.
- 2 year warranty (excluding wear parts) as well as a lifetime lubricated gear box.
- Motor fitted with a bimetallic thermal protection (useable in connection with optional low voltage control).
- Duty cycle 40 % at one operating speed.
- The heavy duty squirrel cage motor has an adjustable spring pressure brake that holds the load secure even in the event of a power failure.
- Motor protected to IP 54, insulation class F. Encapsulated pendant control protected to IP 65.
- Standard operating voltage: Euro-voltage 400 Volt, 3 phase, 50 Hz.
- The 5-pocket load chain sheave, manufactured from wear resistant case hardening steel, is matched perfectly to the load chain to guarantee smooth and precise chain motion.
- The assembly of component parts result in a low overall height (up to 3000 kg only one chain fall).
- The standard, oil bath lubricated planetary gearbox is particularly smooth running.
- Forged suspension and load hooks, manufactured from non-aging, high alloy tempering steel, yield under overload instead of breaking.
- The standard case hardened and zinc-plated link chain is matched perfectly to the load chain to guarantee smooth and precise chain motion. All requirements of national and international standards and regulations are fulfilled.

Option

- 42 V low voltage control.
- Flexible chain container.
- Limit switches for highest and lowest hook positions (in combination with low voltage control).
- Stainless steel load chain.
- Motor with stainless steel brake.
- Other operating voltages.
- Suspension hook rotated 90°.

Twin hoist model CPE 100-2

Capacity 10000 kg

The model CPE 100-2 consists of two CPE 50-2 units. They are connected by a framework. Hook suspension, geared or electric trolleys are available. Integrated limit switches for highest and lowest hook positions are standard. 42 V low voltage control as standard.

Option

- Flexible chain container.
- Stainless steel load chain.
- Motor with stainless steel brake.
- Other operating voltages on request.
- Suspension hook rotated 90°.



! Festooned cable systems see page 104-105



5-pocket load chain sheave machined for smooth, precise chain motion.



Universal connection to suspension hook, trolley or steel structures.



Double fall bottom block for capacities between 3200 up to 5000 kg.



Hoist connected directly to trolley with electric drive. Manual pull and geared trolleys also available.



Optional: Flexible chain container made from wear resistant textile fabric.

! The units are certified by the employer's liability insurance association (Berufsgenossenschaft) and fulfil the requirements of the machinery directive 98/37 EWG.

Hoisting Equipment Electric chain hoists

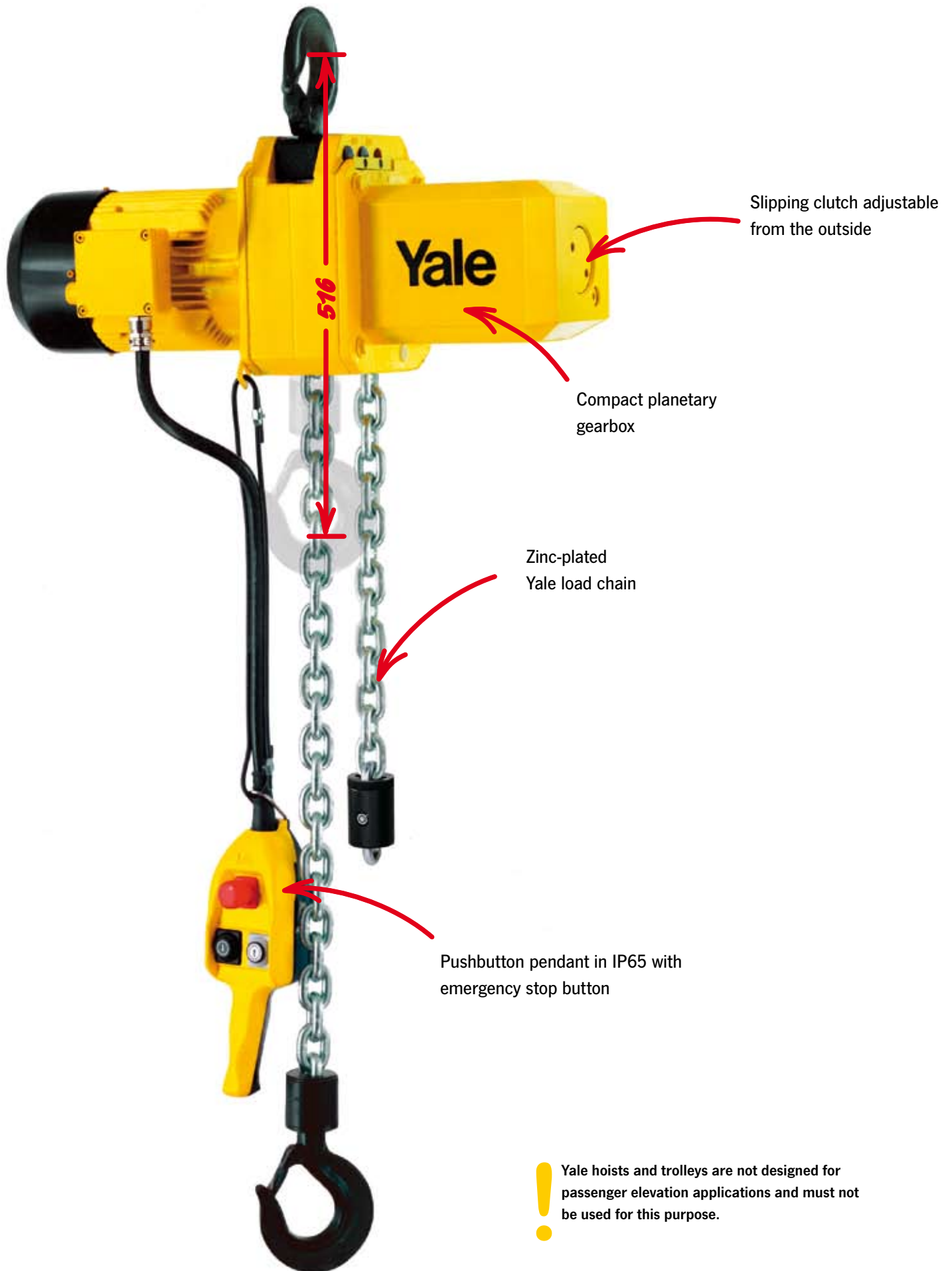

! Yale hoists and trolleys are not designed for passenger elevation applications and must not be used for this purpose.

Hoisting Equipment Electric chain hoists

Technical data model CPE/CPEF

Model	EAN-No. 4025092*	Capacity in kg/ number of chain falls	Chain dimensions d x p mm	FEM classification	Lifting speed main lift m/min	Lifting speed fine lift m/min	Hoist motor kW	Motor rating ED %
CPE 16-8	*073240	1600/1	11 x 31	1 Am	8	-	2.3	40
CPEF 16-8	*073257	1600/1	11 x 31	1 Am	8	2	2.3/0.58	40/20
CPE 20-8	*073264	2000/1	11 x 31	1 Bm	8	-	2.8	25
CPEF 20-8	*073271	2000/1	11 x 31	1 Bm	8	2	2.8/0.7	25/15
CPE 25-5	*073288	2500/1	11 x 31	1 Am	5	-	2.3	40
CPEF 25-5	*073295	2500/1	11 x 31	1 Am	5	1.25	2.3/0.58	40/20
CPE 30-5	*073301	3000/1	11 x 31	1 Bm	5	-	2.8	25
CPEF 30-5	*073318	3000/1	11 x 31	1 Bm	5	1.25	2.8/0.7	25/15
CPE 32-4	*073325	3200/2	11 x 31	1 Am	4	-	2.3	40
CPEF 32-4	*073332	3200/2	11 x 31	1 Am	4	1	2.3/0.58	40/20
CPE 40-4	*073349	4000/2	11 x 31	1 Bm	4	-	2.8	25
CPEF 40-4	*073356	4000/2	11 x 31	1 Bm	4	1	2.8/0.7	25/15
CPE 50-2	*073363	5000/2	11 x 31	1 Am	2.5	-	2.3	40
CPEF 50-2	*073370	5000/2	11 x 31	1 Am	2.5	0.6	2.3/0.58	40/20
CPE 75-1.6	*079907	7500/3	11 x 31	1 Am	1.6	-	2.8	40
CPEF 75-1.6	*079914	7500/3	11 x 31	1 Am	1.6	0.4	2.8/0.58	40/20
CPE 100-2	*060585	10000/4	11 x 31	1 Am	2.5	-	2 x 2.3	40
CPEF 100-2	*060592	10000/4	11 x 31	1 Am	2.5	0.6	2 x 2.3/0.58	40/20

Model	Net weight* suspension hook kg	Net weight* push trolley kg	Net weight* geared trolley kg	Net weight* electric trolley** kg
CPE 16-8	88	150	154	164
CPEF 16-8	93	155	159	169
CPE 20-8	88	150	154	164
CPEF 20-8	93	155	159	169
CPE 25-5	88	150	154	164
CPEF 25-5	93	155	159	169
CPE 30-5	88	150	154	164
CPEF 30-5	93	155	159	169
CPE 32-4	107	169	173	182
CPEF 32-4	112	174	178	187
CPE 40-4	107	169	173	182
CPEF 40-4	112	174	178	187
CPE 50-2	107	169	173	182
CPEF 50-2	112	174	178	187
CPE 75-1.6	-	-	-	-
CPEF 75-1.6	-	-	-	-
CPE 100-2	282	-	385	406
CPEF 100-2	287	-	390	411

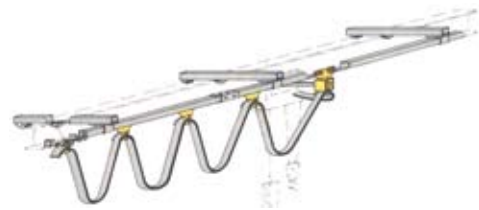

Festooned cable systems
see page 104-105



*Weight for standard 3 m lift. Other lifting heights on request.

**Additional weight for 2 speed version 2.0 kg.

***Limit switches for highest and lowest hook positions - 42 V low voltage control.

Technical data trolleys

Capacity kg	Size	Beam flange width mm	Beam flange thickness t max. mm	Curve radius min. m	Electric trolley travel speed m/min at 50 Hz	Electric trolley motor kW at 50 Hz
1600 - 5000	A	98 - 180	27	2.0	11 or 11/2.8	0.37 or 0.3/0.09
1600 - 5000	B	180 - 300	27	1.8	11 or 11/2.8	0.37 or 0.3/0.09
7500 - 10000	B	125 - 310	40	1.8	5 or 5/1.25	0.55 or 0.55/0.12

Dimensions model CPE/CPEF

Model	CPE/CPEF 16-8	CPE/CPEF 20-8	CPE/CPEF 25-5	CPE/CPEF 30-5	CPE/CPEF 32-4	CPE/CPEF 40-4	CPE/CPEF 50-2	CPE/CPEF 75-1,6	CPE/CPEF 100-2
A, mm	516	516	516	516	681	681	681	950	1068
A1, mm	286	286	286	286	428	428	428	479	651
A2 (13 m), mm	430	430	430	430	430	430	430	-	-
A2 (21 m), mm	530	530	530	530	530	530	530	530	555
B, mm	35	35	35	35	45	45	45	60	60
C, mm	37	37	37	37	46	46	46	52	52
D, mm	24	24	24	24	30	30	30	40/45	40/45
E, mm	24	24	24	24	24	24	24	-	-
F1, mm	160	160	160	160	160	160	160	160	160
F2, mm	178	178	178	178	178	178	178	178	178
G, mm	220	220	220	220	220	220	220	220	705
G1, mm	180	180	180	180	140	140	140	268	315
G2 (13 m), mm	257	257	257	257	218	218	218	-	-
G2 (21 m), mm	277	277	277	277	238	238	238	345	408
H1, mm	110	110	110	110	110	110	110	110	135
H2, mm	135	135	135	135	135	135	135	307	256
K1, mm	100	100	100	100	100	100	100	92	92
K2, mm	51	51	51	51	51	51	51	62	62
M, mm	50	50	50	50	9,6	9,6	9,6	138	-
N, mm	84	84	84	84	124	124	124	136	390
Q1, mm	280	280	280	280	280	280	280	280	280
Q2 (CPE), mm	362	362	362	362	362	362	362	362	362
Q2 (CPEF), mm	417	417	417	417	417	417	417	417	417

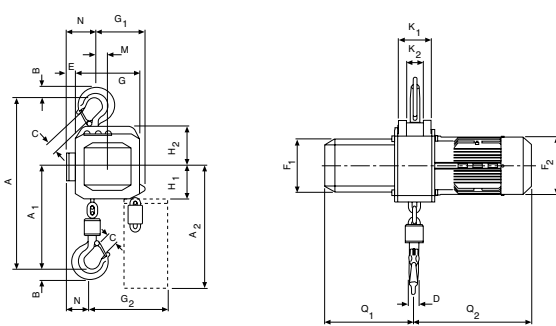

Model CPE/CPEF with suspension hook, 1600 - 3000 kg, single fall

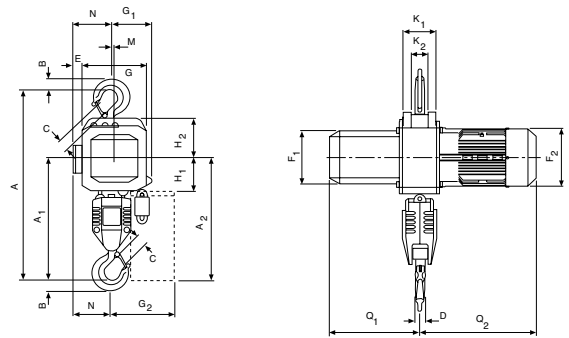

Model CPE/CPEF with suspension hook, 3200 - 5000 kg, double fall

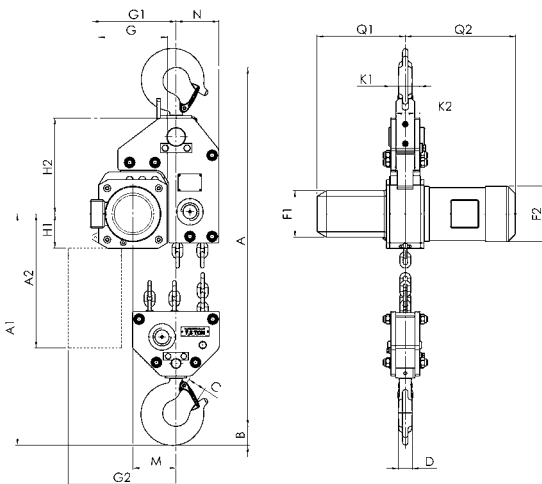

Model CPE/CPEF 75-1,6, with suspension hook, 7500 kg

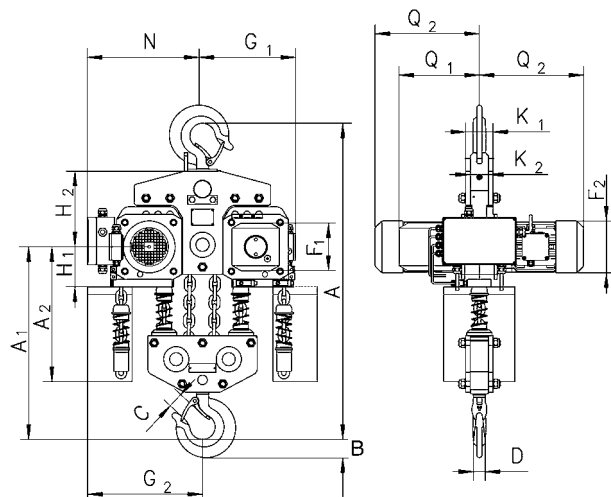

Model CPE/CPEF 100-2 with suspension hook, 10000 kg

Dimensions model CPE/CPEF

Modell	CPE/CPEF 16-8	CPE/CPEF 20-8	CPE/CPEF 25-5	CPE/CPEF 30-5	CPE/CPEF 32-4	CPE/CPEF 40-4	CPE/CPEF 50-2	CPE/CPEF 75-1,6	CPE/CPEF 100-2
A3, mm	143	143	143	143	143	143	143	-	110
A4, mm	465	465	465	465	615	615	615	855	965
A5, mm	298	298	298	298	298	298	298	477	450
A6, mm	178	178	178	178	178	178	178	-	170
b, mm	A = 98 - 180/ B = 180 - 300	A = 98 - 180/ B = 180 - 300	A = 98 - 180/ B = 180 - 300	A = 98 - 180/ B = 180 - 300	A = 98 - 180/ B = 180 - 300	A = 98 - 180/ B = 180 - 300	A = 98 - 180/ B = 180 - 300	A = 98 - 180/ B = 180 - 300	A = 98 - 180/ B = 180 - 300
F, mm	150	150	150	150	150	150	150	113	113
l, mm	142.5	142.5	142.5	142.5	142.5	142.5	142.5	170	170
L1, mm	209	209	209	209	209	209	209	200	200
L2, mm	262.5	262.5	262.5	262.5	262.5	262.5	262.5	215	215
L3 (VTE), mm	292	292	292	292	292	292	292	-	335
L3 (VTEF), mm	296	296	296	296	296	296	296	-	335
L4, mm	213	213	213	213	253	253	253	215	390
L5, mm	312	312	312	312	272	272	272	215	215
L6 (VTE), mm	342	342	342	342	302	342	342	-	-
L6 (VTEF), mm	346	346	346	346	306	306	306	-	-
O, mm	125	125	125	125	125	125	125	150	150
P (VTE), mm	197	197	197	197	197	197	197	-	273
P (VTEF), mm	205	205	205	205	205	205	205	-	280
P1, mm	229	229	229	229	229	229	229	-	110
S, mm	b + 70	b + 70	b + 70	b + 70	b + 70	b + 70	b + 70	b + 98	b + 98
T, mm	97	97	97	97	97	97	97	-	97
tmax., mm	27	27	27	27	27	27	27	40	40

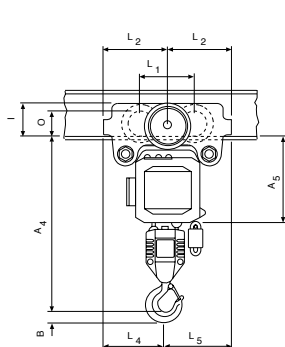

Model CPE/CPEF with integrated push or geared trolley

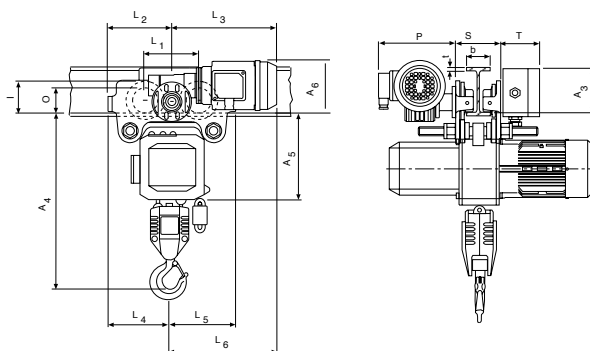

Model CPE/CPEF with integrated electric trolley

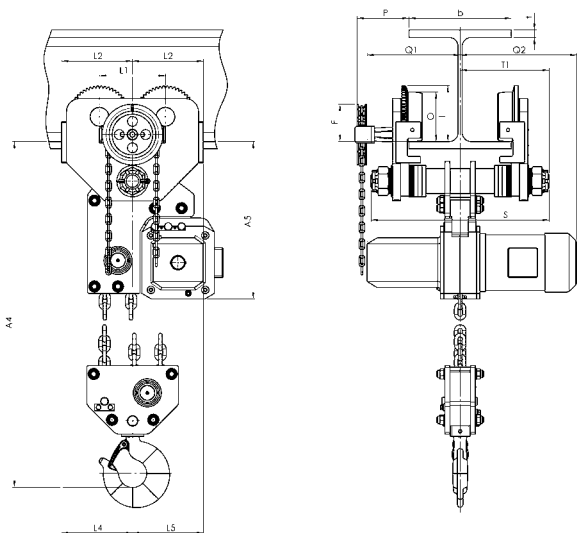

Model CPE/CPEF with integrated geared or electric trolley, 7500 kg

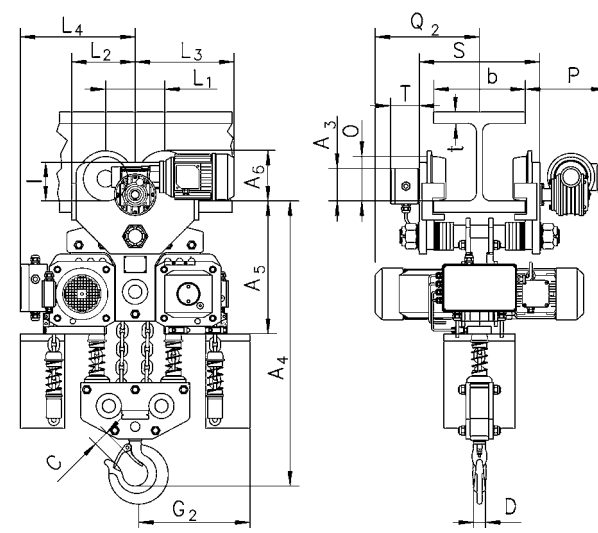

Model CPE/CPEF 100-2 point to point connection with an electric trolley